



LIBERTY GUARD



Stand alone health and welfare units

26' x 9'



The most comprehensive unit
available on the market today

the Junior Plus

also available as the Junior Plus Shower

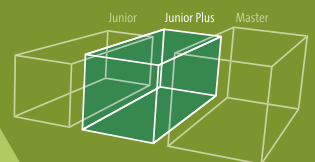

- ◆ High-tech steel anti-vandal specification
- ◆ Operational within 10 minutes of arrival and ready for use
- ◆ No mains required
- ◆ Self-housed Generator
- ◆ Delivered fully serviced and ready to use
- ◆ Fully self-contained unit with canteen, office, toilet, wash and drying room
- ◆ External electrical connection (For additional 'plug in' accommodation units on site)
- ◆ Air conditioning fitted as standard (hot and cold temperature)

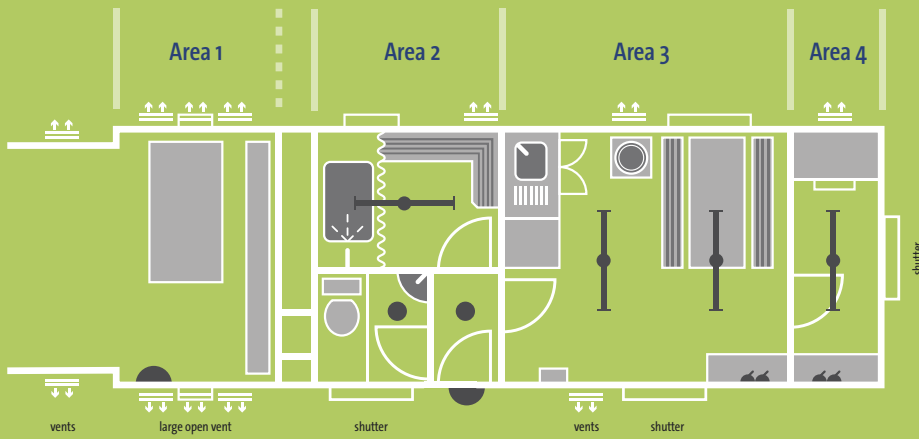

Welfare Unit standard fittings

- Lifting** 12mm Lifting Eyes at each corner
- Siting** Heavy duty Jacking Legs
- Floor** Steel bearers overlaid with 19mm flooring plywood. Finished in vinyl floor covering
- Electrical installation** Standard electrical installation features – 100 amp consumer unit with RCD protection • MCB's
- Vents** 4 x High Level and 4 x Low Level vents
- Wall Linings** Walls finished in EGB52 polyester coated plywood
- Ceilings** Ceiling finished in white CSM10 polyester coated plywood
- Partitioning** To form toilet area, drying room, canteen and office

the Junior Plus – floorplan and fittings (26' x 9') Air conditioning fitted as standard

The Liberty Junior Plus comprises of two separate steel units. The generator etc is housed in its own 6' x 9' shell, with the main welfare unit located within a 26' x 9' unit. Connections between the units are site fixed. The units are manufactured from 1.6mm Corrugated Steel to walls, roof and doors. Corner posts are made from 3mm steel.

Area 1

- 9' x 6' Generator Housing**
 2884mm double steel doors, internal security hinges, 2 x 5 lever insurance deadlocks, 1 x insurance padlock within steel shroud, leading to generator area.
 Heavy duty Jacking Legs • 12mm Lifting Eyes at each corner.
- Generator Area**
 Separated from main area by steel partition
 • Diesel engine 15kva generator • 800 litre bunded diesel tank • 875 litre water tank
 • 15 litre multipoint water heater feeding Canteen and Toilet sinks • Water pump • Control Panel. (situated in Entrance Lobby)

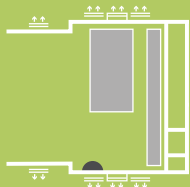

Area 2

- Drying Room**
 Timber bench seating with steel support legs
 • Hat and coat hooks on timber rail
 • 1 kw Frostfighter radiant fan heater
 • One gang one way light switch • 1200mm Fluorescent light fitting.
- Shower Area (Only in Junior Plus Shower)**
 1 x shower tray and instant shower heater positioned in Drying Room area, c/w shower curtain
- Toilet**
 One gang one way light switch • Bulkhead light fitting • 560mm wash hand basin
 • Non-concussive basin taps • Mirror • Coat hook • No-mains chemical toilet system
 • In-line extractor fan.



Area 3 – Area 4

- External Personnel Door**
 1100mm High Security steel door, hooking onto external wall. Internal security hinges. Steel door handle operating a 20mm steel rod located behind door frame and through floor, locked by a 5 Lever insurance deadlock • Unit accessed by ½ glazed internal door with 6.4mm laminated glass c/w 3 lever mortice lock and door closure.
- External Windows**
 800mm x 975mm top opening vent aluminium framed window, protected by 3mm steel vertical sliding shutter. Operated internally with unique pulley system and hidden pull cords. High level obscure glazed window, protected by welded steel grill.
- Entrance Lobby (also giving access to Toilet and Drying Room)**
 One gang one way light switch • Bulkhead light fitting • 3 x internal doors leading to toilet, drying room and canteen • Control panel for generator.
- Canteen Area**
 One gang one way light switch • 2 x 1500mm fluorescent light fittings • 1000mm x 600mm stainless steel sink unit • Pair non-concussive basin taps • 1000mm sink base unit • 1000mm wall unit • Worktop • Refrigerator • Microwave oven • 2 x twin switched socket outlets • Insectcutor • Powwow fresh water drinks dispenser • Powwow bottle rack • Wall mounted waste bin • Air conditioning/Heater Unit • Steel framed fixed bench seating • Canteen table with steel support leg • Fire Blanket.
- Office (access gained through canteen area)**
 One gang one way light switch • 600mm x 600mm surface mounted modular light with Cat 2 Louvre • Work desk with shelf above • Upholstered side chair • Hat and coat hooks • Drop down drawing table • Notice boards • 100mm extractor fan • 2 x twin switched socket outlets • Generator control panel.

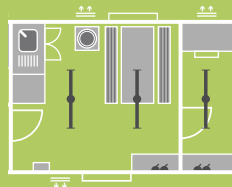

the Junior Plus and Junior Plus Shower from...



Stand alone health and welfare units

Supplied Nationwide

For more information please call **01302 730033** or visit **libertyguard.co.uk**
 Liberty Guard (UK) Limited, Liberty House, Unit 4, Potteric Carr Industrial Estate, Doncaster DN4 5JB